

HSF

NOTES:

Rated Current:10.0AMP.(20°C,1*2P-1*10P)
7.0AMP.(20°C,1*11P-1*20P) A2

Contact Resistance:20mΩ Max.

Withstand Voltage:1000V AC/DC

Insulation Resistance:1000MΩ Min.

Operation Temperature: -40°C to +105°C(Tin Plating)

Contact Material:Copper Alloy

Contact Plating:Sn Over 30u" Min Ni

Insulator Material:LCP+G.F UL94V-0 BK A2

Ordering Information

1832-1 1 XX XX R XXX D 0 XX

Plastic Layer
Plastic Row
No. of Pins Per Row:02-20
Contact Plating
SN=Bright Tin
SM=Matte Tin A2

Series No. 01-99
Packing 0=PE Bag
Insulator Material D=LCP
Pin Length L(See Table)
Type: R=R/A

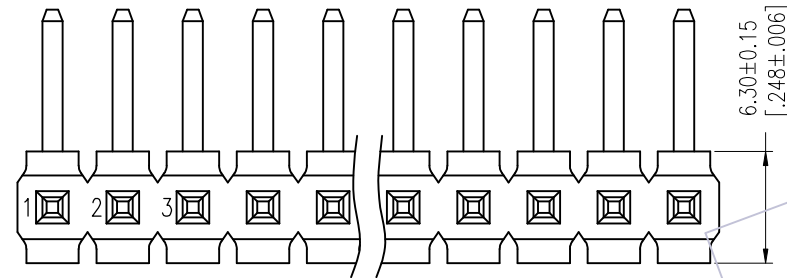

Recommended P.C.B Layout (Top Side)
(PCB BOARD TOLERANCE±0.05)
(PCB Thickness:T=1.60mm)

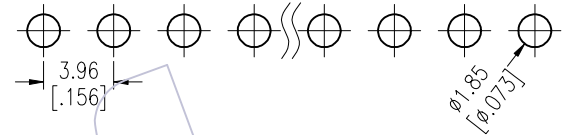

A2 Packaging Quantity Refers To The Following Table

PINS	Q' ty/Bag (22.5 ≤ L ≤ 23.2)
2	300
3	300
4	200
5	200
6	100
7	100
8	100
9	100
10	100
11	80
12	80
13	80
14	50
15	50
16	50
17	50
18	50
19	50
20	50

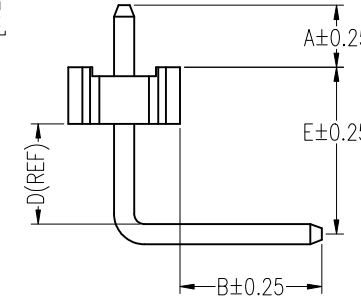
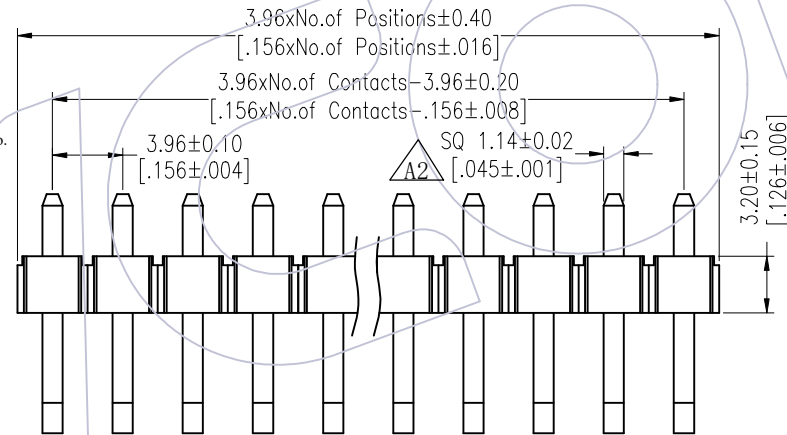

Packing:

Item	Pin Length	A	D	E	B	Mating
Standard	23.2	3.6	5.65	9.42	8.0	2889
	22.5	2.8 (THR)	5.65	9.42	8.0	2889
Alternate						

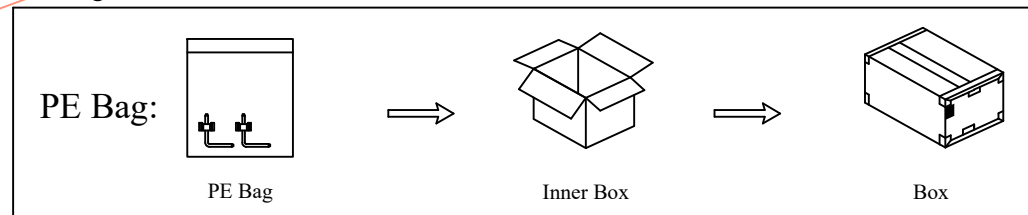

REV	DATE	MODIFICATION DESCRIPTION	CHANGE	OPERATION	DRAW	DATE	SCALE	Fit	PART NO.
A2	2025/10/07	Standardization Drawing	CP	x.X ±0.40	CP	2025/10/07	UNIT	mm [inch]	1832-11XXXXRXXXDXXX A2
A1	2018/01/23	MODIFY PART NO.	William Chen	x.XX ±0.25	CHECK TANG	2025/10/07	SIZE	A4	TITLE: 3.96 Pin Header, SINGLE ROW, R/A, PLANE BENDING, H=3.2
AO	2012/06/25	NEW	William Chen	x.XXX ±0.15	APPROVE Steven Zhao	2025/10/07	SHEET	1/1	Customer NO.
				Angle ± 3'			PROJ.		
				DIM TOL					

WCON

Http: www.wcon.com

WCON-Dongguan Tel: +86 769 85358920 Fax: +86 769 85358915 E-mail: sales@wcon.com

WCON-Kunshan Tel: +86 512 57468408 Fax: +86 512 57468468 E-mail: sales@wcon.com