

Four-point contact
四点接触

Overview

2.50mm pitch WF2508 series is crimp type, anti-wrong plugging structure, and with TPA secondary locking structure, to improve the holding force and intermating high stability, diversity of installation to meet the customer's different needs of the mating angle for the equipment to provide signal transmission wire to board automotive connector products.

Features and Benefits

- Flexible and diverse installation and matching methods
- 4-point contact for terminals, stable contact, anti-vibration and shock resistance.
- With TPA structure, increase the holding power of wire end.
- Locking with tactile and acoustic feedback to ensure safe fit.
- Anti-wrong plugging structure to avoid effective wrong plugging.

Product Applications

- Automotive: headlight control, telemetry equipment
- Industrial: industrial control
- Medical: patient monitors
- Consumer: appliance control

Standard 标准

- QC/T 1067

Material 材料

Part/零件	Material/材料	Finish/电镀	UL Flame retardant/阻燃等级
Housing/主体	PA46	Black/黑色 Tatural/本色	UL94V-0
Header/板端	LCP	Black/黑色 Tatural/本色	UL94V-0
Terminal/端子	Copper Alloy 高导电铜 (C7025)	Gold or Tin plated 镀金或镀锡	-
TPA/二次锁止机构	PA46	Black/黑色 Tatural/本色 Orange /橙色	UL94V-0

概述

2.50mm间距WF2508系列是压接式、防错插结构，且带有TPA二次锁止结构，提高保持力和互配高稳定性，多样性的安装方式满足客户不同需求的对插角度，为设备提供信号传输的线到板汽车连接器产品。

产品特点

- 灵活多样的安装及配合方式
- 端子采用四点接触，接触稳定、抗振动耐冲击
- 带TPA结构、增加线端的保持力
- 锁扣配合带有触觉与声音的反馈，确保安全配合
- 防错插结构，避免有效错插

应用领域

- 汽车：车灯控制、遥测设备
- 工业：工业控制
- 医疗：病人监护仪
- 消费类：家电控制

Production Specifications 产品规格

Current rating 额定电流	3.0~8.0A	Operating Temperature Range:-40° C~+125° (including temperature rise) Operating Humidity Range:20-80% 工作温度范围: -40° C~+125° C(含温升) 工作湿度范围: ≤80%	Storage Temperature: Operating Humidity: 储存温度: 25±5° C 储存湿度: ≤60%
Voltage rating 额定电压	250V		

Item 项目	Condition 条件	Specification 规格
Insulation Resistance 绝缘电阻	Measured at 500V DC for 1 minute 测试电压: 500V DC/1分钟	No less than 1000M Ω 不少于1000MΩ
Withstanding voltage 耐电压	Measured at 1500V AC for 1 minute 测试电压: 1500V AC/1分钟	No breakdown, no discharge, leakage current <1.0 mA 无击穿、无放电、漏电流<1.0 mA
Contact Resistance 接触电阻	Measured at 100mA and no higher than 20mV 用20 mV DC进行测量	Contact resistance: Initial value/ 10 mo max After environmental tests/ 20 mo max. 接触电阻: 初始值 10 mΩ 以下 测试后 20 mΩ 以下
Vibration Resistance 抗振动	Vibration Frequency : 60~1200Hz Vibration Direction : X,Y,Z; Duration : 8 h each; (fig 3) 震动频率: 60~1200HZ 震动方向: X,Y,Z 持续时间: 8H各方向	1.No electrical discontinuity greater than 1μS. Shall occur. 2.Contact Resistance:20 mΩmax(Final). 1.不发生大于1μS.瞬断 2. 接触电阻20 mΩ max(实验后).
Humidity (Steady state) 湿度	Mated connectors , -40~125°C, 90~95% R.H. , 10 cycles (1cycle=24hours),Performed (fig 4) 配对连接器温度范围: -40~125°C 湿度: 90~95% R.H 10次循环 (1个循环 24H)	Contact resistance: Initial value/ 10 mo max After environmental tests/ 20 mo max. 接触电阻: 初始值 10 mΩ 以下 测试后 20 mΩ 以下
Salt Spray 盐雾	Temperature:35#2°C Humidity:95~98%(R.H) PHValue : 6.5 ~ 7.2 Duration : Tin:24hours; Au: 48hours 温度: 35±2° C 湿度: 95~98%(R.H) PH值: 6.5~7.2 时间: 镀锡24H; 镀金48H	Contact resistance: Initial value/ 10 mo max After environmental tests/ 20 mo max. 接触电阻: 初始值 10 mΩ 以下 测试后 20 mΩ 以下
Durability(Mating/un- mating) 插拔寿命	50 cycles 循环50次	Contact resistance: Initial value/ 10 mo max After environmental tests/ 20 mo max. 接触电阻: 初始值 10 mΩ 以下 测试后 20 mΩ 以下

WF2508 Series

Dimensions 尺寸 (R/A SMT)

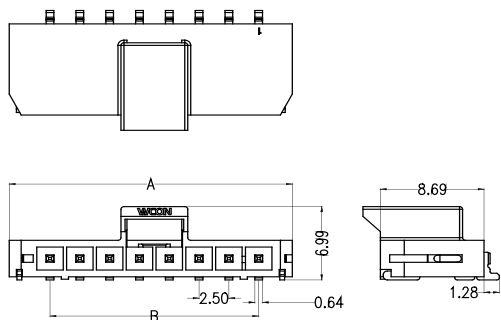

Ordering Information 订购信息

Circuit 芯数	Part number 型号	Dimensions 尺寸 (mm)		Package 包装 Q'ty/Reel 只/卷装	Remake 可量产状态
		A	B		
2	WF2508-1WZH02XXXXXR1	8.74	2.50	550	
3	WF2508-1WZH03XXXXXR1	11.24	5.00	550	
4	WF2508-1WZH04XXXXXR1	13.74	7.50	550	
5	WF2508-1WZH05XXXXXR1	16.24	10.00	550	
6	WF2508-1WZH06XXXXXR1	18.74	12.50	550	
7	WF2508-1WZH07XXXXXR1	21.24	15.00	550	
8	WF2508-1WZH08XXXXXR1	23.74	17.50	550	*

Note: * stands for mass production . 注: *代表可量产

Assembly Schematic 装配示意

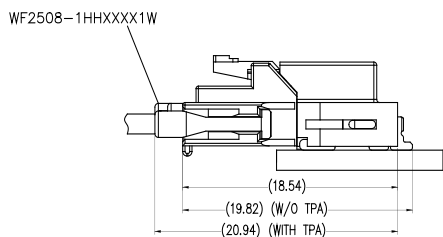

PCB Layout 印刷电路板布局

SMT type 表面贴装型

R/A SMT (Single Row 单排)

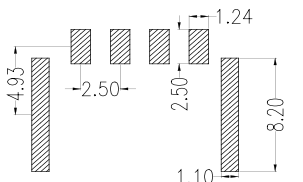

Dimensions 尺寸 (S/T SMT)

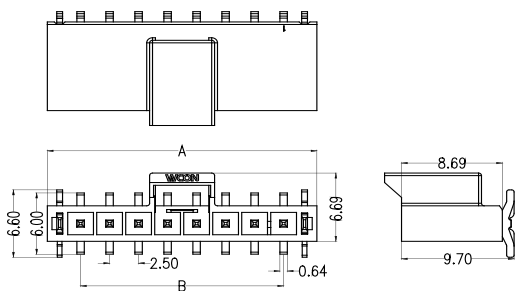

Ordering Information 订购信息

Circuit 芯数	Part number 型号	Dimensions 尺寸 (mm)		Package 包装 Q'ty/Reel 只/卷装	Remake 可量产状态
		A	B		
2	WF2508-1WMH02XXXXXR1	8.23	2.50	330	
3	WF2508-1WMH03XXXXXR1	10.73	5.00	330	
4	WF2508-1WMH04XXXXXR1	13.23	7.50	330	
5	WF2508-1WMH05XXXXXR1	15.73	10.00	330	
6	WF2508-1WMH06XXXXXR1	18.23	12.50	330	
7	WF2508-1WMH07XXXXXR1	20.73	15.00	330	
8	WF2508-1WMH08XXXXXR1	23.23	17.50	330	*

Note: * stands for mass production . 注: *代表可量产

Assembly Schematic 装配示意

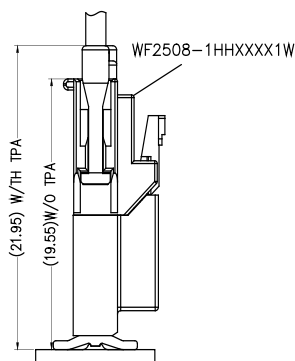

PCB Layout 印刷电路板布局

SMT type 表面贴装型

S/T SMT (Single Row 单排)

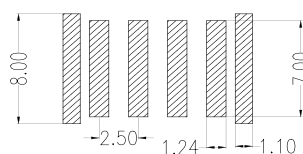

Dimensions 尺寸 (R/A SMT)

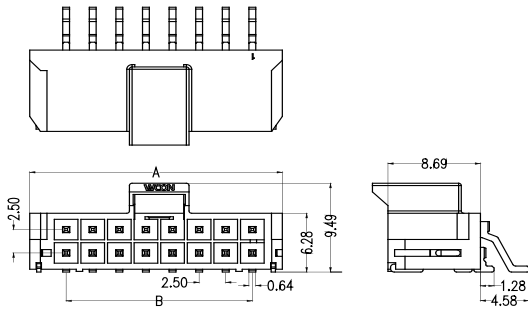

Ordering Information 订购信息

Circuit 芯数	Part number 型号	Dimensions 尺寸 (mm)		Package 包装 Q'ty/Reel	Remake 可量产状态
		A	B		
4	WF2508-2WZH02XXXX1	8.74	2.50	250	
6	WF2508-2WZH03XXXX1	11.24	5.00	250	
8	WF2508-2WZH04XXXX1	13.74	7.50	250	
10	WF2508-2WZH05XXXX1	16.24	10.00	250	
12	WF2508-2WZH06XXXX1	18.74	12.50	250	
14	WF2508-2WZH07XXXX1	21.24	15.00	250	*
16	WF2508-2WZH08XXXX1	23.74	17.50	250	*

Note: * stands for mass production . 注: *代表可量产

Assembly Schematic 装配示意

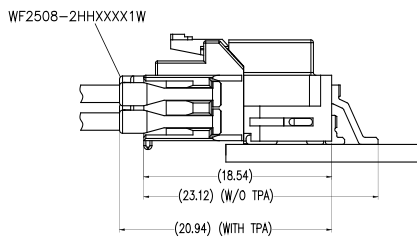

PCB Layout 印刷电路板布局

SMT type 表面贴装型

R/A SMT (Dual Row 双排)

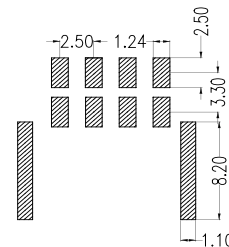

Dimensions 尺寸 (S/T SMT)

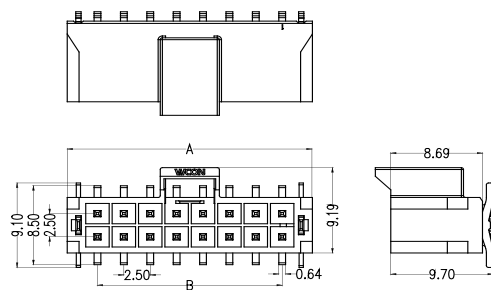

Ordering Information 订购信息

Circuit 芯数	Part number 型号	Dimensions 尺寸 (mm)		Package 包装 Q'ty/Reel 只/卷装	Remake 可量产状态
		A	B		
4	WF2508-2WMH02XXXX1	8.23	2.50	270	
6	WF2508-2WMH03XXXX1	10.73	5.00	270	
8	WF2508-2WMH04XXXX1	13.23	7.50	270	
10	WF2508-2WMH05XXXX1	15.73	10.00	270	
12	WF2508-2WMH06XXXX1	18.23	12.50	270	
14	WF2508-2WMH07XXXX1	20.73	15.00	270	*
16	WF2508-2WMH08XXXX1	23.23	17.50	270	*

Note: * stands for mass production . 注: *代表可量产

Assembly Schematic 装配示意

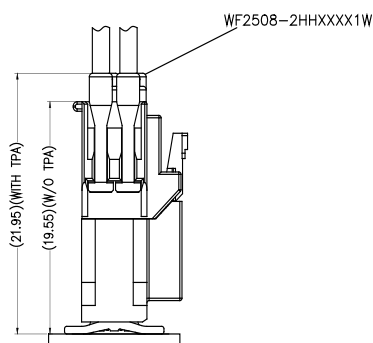

PCB Layout 印刷电路板布局

SMT type 表面贴装型

S/T SMT (Dual Row 双排)

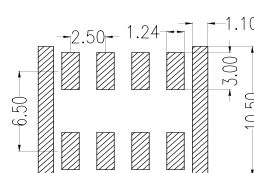

WF2508 Series

Dimensions 尺寸 (S/T DIP)

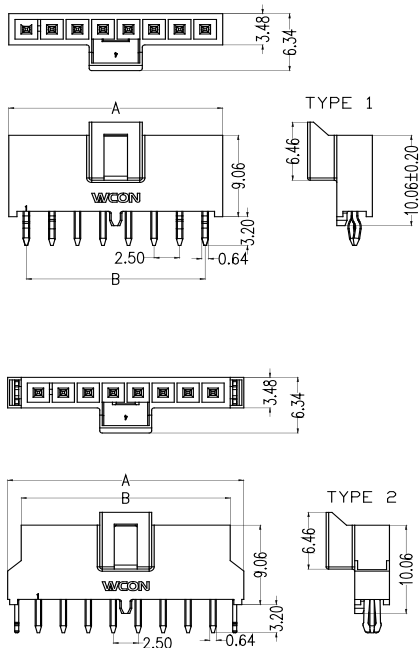

Assembly Schematic 装配示意

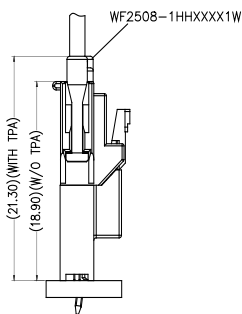

Dimensions 尺寸 (R/A DIP)

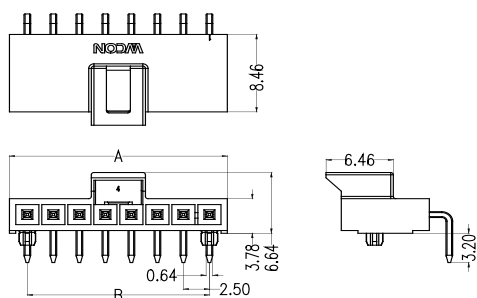

Assembly Schematic 装配示意

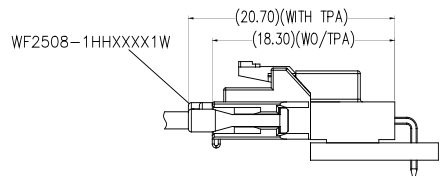

Ordering Information 订购信息

Circuit 芯数	Part number 型号	Dimensions 尺寸 (mm)		Parkage 包装 Q'ty/Tray 只/盒装	Remake 可量产状态
		A	B		
2	WF2508-1WSH02XXXX1	5.94	2.50	235	*
3	WF2508-1WSH03XXXX1	8.44	5.00	165	
4	WF2508-1WSH04XXXX1	10.94	7.50	125	*
5	WF2508-1WSH05XXXX1	13.44	10.00	105	*
6	WF2508-1WSH06XXXX1	15.94	12.50	85	
7	WF2508-1WSH07XXXX1	18.44	15.00	75	
8	WF2508-1WSH08XXXX1	20.94	17.50	65	*

Circuit 芯数	Part number 型号	Dimensions 尺寸 (mm)		Parkage 包装 Q'ty/Tray 只/盒装	Remake 可量产状态
		A	B		
2	WF2508-1WSH02XXXX2	8.66	5.94	160	*
3	WF2508-1WSH03XXXX2	11.16	8.44	125	
4	WF2508-1WSH04XXXX2	13.66	10.94	100	*
5	WF2508-1WSH05XXXX2	16.16	13.44	85	*
6	WF2508-1WSH06XXXX2	18.66	15.91	75	
7	WF2508-1WSH07XXXX2	21.16	18.44	65	
8	WF2508-1WSH08XXXX2	23.66	20.94	60	

Note: * stands for mass production . 注: *代表可量产

PCB Layout 印刷电路板布局

Through-hole type 通孔型
S/T DIP (Single Row) Type 1

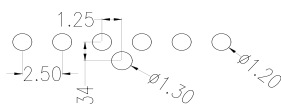

Through-hole type 通孔型
S/T DIP (Single Row) Type 2

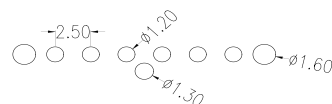

Ordering Information 订购信息

Circuit 芯数	Part number 型号	Dimensions 尺寸 (mm)		Parkage 包装 Q'ty/Tray 只/盒装	Remake 可量产状态
		A	B		
2	WF2508-1WRH02XXXX1	5.94	2.50	672	*
3	WF2508-1WRH03XXXX1	8.44	5.00	476	*
4	WF2508-1WRH04XXXX1	10.94	7.50	364	*
5	WF2508-1WRH05XXXX1	13.44	10.00	294	*
6	WF2508-1WRH06XXXX1	15.94	12.50	252	*
7	WF2508-1WRH07XXXX1	18.44	15.00	210	*
8	WF2508-1WRH08XXXX1	20.94	17.50	182	*

Note: * stands for mass production . 注: *代表可量产

PCB Layout 印刷电路板布局

Through-hole type 通孔型
R/A DIP (Single Row 单排)

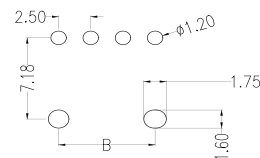

Dimensions 尺寸 (S/T DIP)

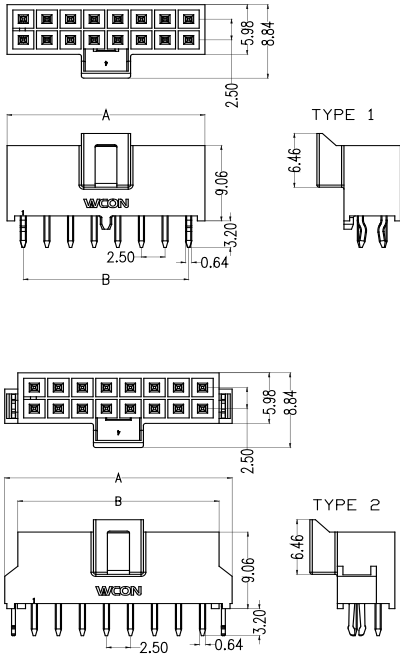

Assembly Schematic 装配示意

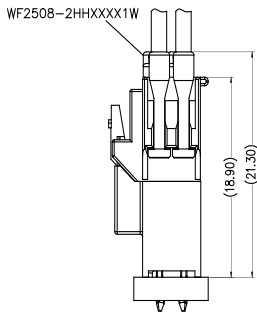

Dimensions 尺寸 (R/A DIP)

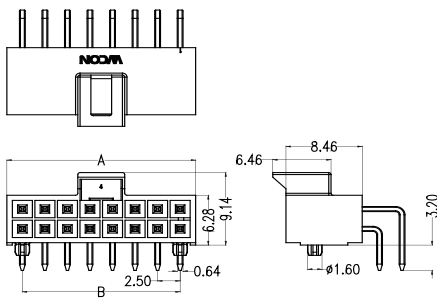

Assembly Schematic 装配示意

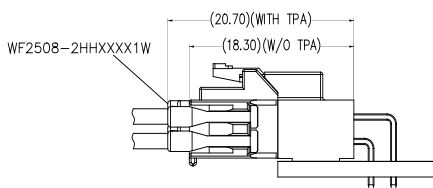

Ordering Information 订购信息

Circuit 芯数	Part number	Dimensions 尺寸 (mm)		Parkage 包装 Q'ty/Tray 只/盒装	Remake 可量产状态
		A	B		
	TYPE-1				
4	WF2508-2WSH02XXXX1	5.94	2.50	240	*
6	WF2508-2WSH03XXXX1	8.44	5.00	165	*
8	WF2508-2WSH04XXXX1	10.94	7.50	130	
10	WF2508-2WSH05XXXX1	13.44	10.00	105	
12	WF2508-2WSH06XXXX1	15.94	12.50	85	*
14	WF2508-2WSH07XXXX1	18.44	15.00	75	*
16	WF2508-2WSH08XXXX1	20.94	17.50	65	

Circuit 芯数	Part number	Dimensions 尺寸 (mm)		Parkage 包装 Q'ty/Tray 只/盒装	Remake 可量产状态
		A	B		
	TYPE-2				
4	WF2508-2WSH02XXXX2	8.66	5.94	165	*
6	WF2508-2WSH03XXXX2	11.16	8.44	125	
8	WF2508-2WSH04XXXX2	13.66	10.94	100	
10	WF2508-2WSH05XXXX2	16.16	13.44	85	
12	WF2508-2WSH06XXXX2	18.66	15.91	75	
14	WF2508-2WSH07XXXX2	21.16	18.44	65	
16	WF2508-2WSH08XXXX2	23.66	20.94	60	*

Note: * stands for mass production . 注: *代表可量产

PCB Layout 印刷电路板布局

Through-hole type 通孔型
S/T DIP (Dual Row 双排) Type 1

Through-hole type 通孔型
S/T DIP (Dual Row 双排) Type 2

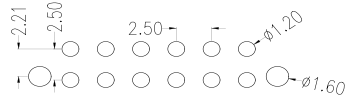
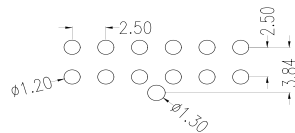

Ordering Information 订购信息

Circuit 芯数	Part number 型号	Dimensions 尺寸 (mm)		Parkage 包装 Q'ty/Tray	Remake 可量产状态
		A	B		
4	WF2508-2WRH02XXXX1	5.94	2.50	528	*
6	WF2508-2WRH03XXXX1	8.44	5.00	374	*
8	WF2508-2WRH04XXXX1	10.94	7.50	286	*
10	WF2508-2WRH05XXXX1	13.44	10.00	231	
12	WF2508-2WRH06XXXX1	15.94	12.50	198	*
14	WF2508-2WRH07XXXX1	18.44	15.00	165	*
16	WF2508-2WRH08XXXX1	20.94	17.50	143	*

Note: * stands for mass production . 注: *代表可量产

PCB Layout 印刷电路板布局

Through-hole type 通孔型
R/A DIP (Dual Row 双排)

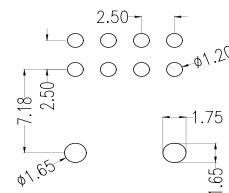

WF2508 Series

Dimensions 尺寸 (Single Row 单排)

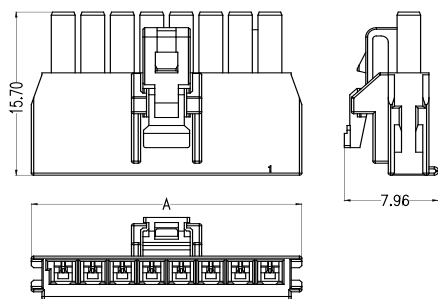

Ordering Information 订购信息

Circuit 芯数	Part number 型号	Dimensions 尺寸 (mm)	Package 包装 Q'ty/Bag 只/袋装	Remake 可量产状态
		A		
2	WF2508-1HH02XX1W	7.70	500	*
3	WF2508-1HH03XX1W	10.20	500	
4	WF2508-1HH04XX1W	12.70	500	
5	WF2508-1HH05XX1W	15.20	500	*
6	WF2508-1HH06XX1W	17.70	300	
7	WF2508-1HH07XX1W	20.20	300	
8	WF2508-1HH08XX1W	22.90	300	*

Note: * stands for mass production . 注: *代表可量产

Dimensions 尺寸 (Dual Row 双排)

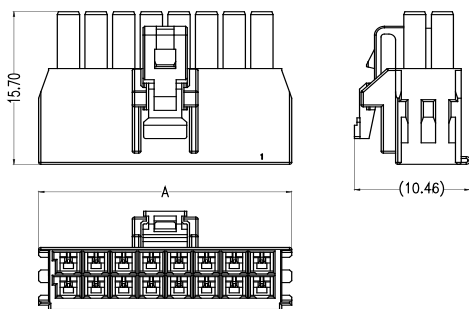

Ordering Information 订购信息

Circuit 芯数	Part number 型号	Dimensions 尺寸 (mm)	Package 包装 Q'ty/Bag 只/袋装	Remake 可量产状态
		A		
4	WF2508-2HH02XX1W	7.70	500	*
6	WF2508-2HH03XX1W	10.20	500	*
8	WF2508-2HH04XX1W	12.70	500	*
10	WF2508-2HH05XX1W	15.20	500	*
12	WF2508-2HH06XX1W	17.70	300	*
14	WF2508-2HH07XX1W	20.20	300	
16	WF2508-2HH08XX1W	22.70	300	*

Note: * stands for mass production . 注: *代表可量产

Dimensions 尺寸

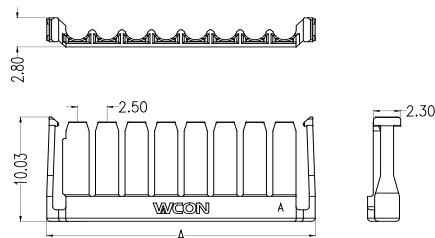

Ordering Information 订购信息

Circuit 芯数	Part number 型号	Dimensions 尺寸 (mm)	Package 包装 Q'ty/Bag 只/袋装	Remake 可量产状态
		A		
2	GWF2508-1C02X01	7.70	6000	*
3	GWF2508-1C03X01	10.20	5000	*
4	GWF2508-1C04X01	12.70	4000	*
5	GWF2508-1C05X01	15.20	3000	*
6	GWF2508-1C06X01	17.70	2400	*
7	GWF2508-1C07X01	20.20	2100	*
8	GWF2508-1C08X01	22.70	2100	*

Note: * stands for mass production . 注: *代表可量产

Ordering Information 订购信息

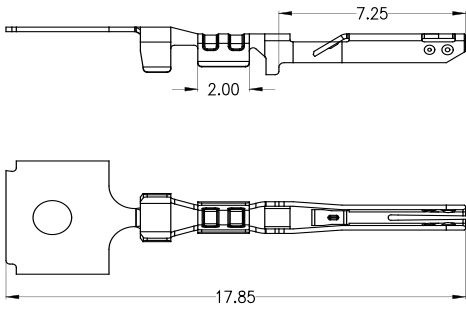

型号 Model number	材料 Material	电镀 Plating	导线范围 Wire Range
WF2508-TCSN01	Copper Alloy	Tin	AWG#20~22
WF2508-TCSN02	Copper Alloy	Tin	AWG#24~26

Terminal Crimp specification 端子压接规范

型号 Model number	电线类型 Wire type	电线规格 Wire size	线缆 OD (mm) Cable OD (mm)	剥线长度 (mm) Strip length (mm)	导体铆压 (A-A) Conductor crimp			绝缘体铆压 (B-B) Insulation crimp	
					压接宽度CB1 Crimping width CB1±0.03mm	压接宽度CBm1 Crimping height CBm1+0.05mm	压接高度 Crimping height CH1±0.03mm	压接宽度CBm2 Crimping width CBm2±0.05mm	压接高度CH2 Crimping width CH2±0.08mm
WF2508-TCSN01	FLRY-A	20AWG	1.50±0.1	3.10±0.2	1.45	1.45	0.75	1.95	1.55
	AVSS	20AWG	1.60±0.1		1.45	1.45	0.75	1.95	1.55
	UL1332	20AWG	1.60±0.1		1.45	1.45	0.75	1.95	1.55
	FLRY-A	22AWG	/		/	/	/	/	/
	AVSS	22AWG	/		/	/	/	/	/
	UL1332	22AWG	/		/	/	/	/	/
WF2508-TCSN02	FLRY-A	24AWG	1.10±0.1	3.10±0.2	1.15	1.18	0.72	1.60	1.45
	AVSS	24AWG	1.20±0.1		1.15	1.18	0.72	1.60	1.45
	UL1332	24AWG	1.20±0.1		1.15	1.18	0.72	1.60	1.45
	UL1332	26AWG	1.10±0.1		1.17	1.17	0.70	1.62	1.40

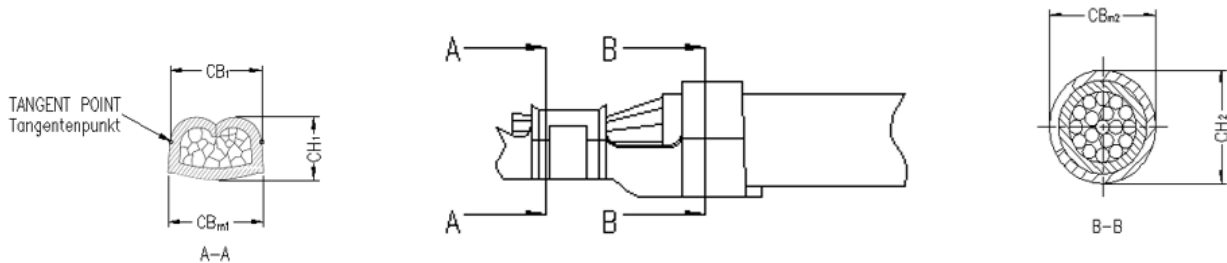

WF2508 Series

Model number allocation 型号命名

WF2508	-	X	XX	H	XX	XX	X	X	1
(1)	(2)	(3)	(4)	(5)	(6)	(7)	(8)	(9)	
(1) Series (系列): Wafer 2.50mm Series						(6) Contact Plating (电镀): Blank=Tin SX=xx u" Gold /Tin			
(2) Row number (排数): 1=Single Row 2=Dual Row						(7) Color (颜色): T=Natural B=Black			
(3) Terminal type (端子形态): WM=S/T SMT WZ=R/A SMT WS=S/T DIP WR=R/A DIP						(8) Packing (包装): A=Tray R=Reel			
(4) Material (材质): H=High-temperature plastics						(9) Internal code (流水码)			
(5) Circuit (位数): 02=2P.....08=8P									

WF2508	-	X	H	H	XX	X	X	1
(1)	(2)	(3)	(4)	(5)	(6)	(7)	(8)	
(1) Series (系列): Wafer 2.50mm Series					(5) Circuit (位数): 02=2P.....08=8P			
(2) Row number (排数): 1=Single Row 2=Dual Row					(6) Color (颜色): T=Natural B=Black			
(3) Class shape code (类形状代码): H=Housing(TPA)					(7) Packing (包装): A=Tray 0=PE			
(4) Product type (产品类型): H=Crimp Type Housing					(8) Internal code (流水码)			

Contact Us 联系我们

维峰电子股份有限公司(总部)
WCON ELECTRONICS CO.,LTD(HQ)
地址:广东省东莞市虎门镇大宁文明路15号
Add :No.15,Wenming Road,Daning Community, Humen Town,
Dongguan, Guangdong,523930, China

昆山维康电子有限公司
KUNSHAN WCON ELECTRONICIS CO.,LTD(East of China)
地址:江苏昆山市千灯镇汶浦中路169号
Add : No.169, WenPu Middle Road, QianDeng Town, Kunshan
City, Jiangsu Province, China

合肥维峰电子有限公司
HEFEI WCON ELECTRONICIS CO.,LTD
地址:安徽合肥市高新技术开发区绿城科技园E栋2楼
Add : 2F, Building E, Greentown Science Park,High-tech Develop-
ment Zone, Hefei, Anhui,China

维康电子(泰国)有限公司
WCON ELECTRONICS (Thailand) CO.,LTD
地址:泰国巴真武里府西玛铺县华瓦区洛加纳工业园
Add: VG3C+H57, Hua Wa, Si Maha Phot District, Prachin Buri
25140, Thailand

销售联系方式 Sales Contacts

国际客户部 International Sales Department
salesdg01@wcon.com
salesdg05@wcon.com

大客户专线 Key Account Line
华南: salesdg28@wcon.com
华东: salesks@wcon.com

中小客户专线 Small and Medium-sized Account Line
华南: salesdg10@wcon.com
华东: salesks01@wcon.com

网络销售 Online sales
salesdg26@wcon.com



Official Website



Product e-catalog



WeChat Public#



TikTok Public#