

HSF

NOTES:

Rated Current:5.0AMP.(20°C,2*2P-2*15P)
3.0AMP.(20°C,2*16P-2*40P) A2

Contact Resistance:20mΩ Max.

Withstand Voltage:1000V AC/DC

Insulation Resistance:1000MΩ Min.

Operation Temperature:-40°C to +125°C(Gold Plating) A2
-40°C to +105°C(Tin Plating)

Contact Material:Copper Alloy

Contact Plating:Au or Sn Over 30u" Min Ni A2

Insulator Material:PA9T+G.F UL94V-0 BK A2

Ordering Information

1120-1 2 XX XX S XXX C 0 XX A1

Plastic Layer
Plastic Row
No. of Pins
Per Row:02-40
Contact Plating
G0=Gold Flash
G3=10u"Au, BG3=8u"PdNi+2u"Au
G4=15u"Au, BG4=13u"PdNi+2u"Au
G5=30u"Au, BG5=28u"PdNi+2u"Au
S0=Gold Flash/Tin
S3=10u"Au/Sn, P3=8u"PdNi+2u"Au/Sn
S4=15u"Au/Sn, P4=13u"PdNi+2u"Au/Sn
S5=30u"Au/Sn, P5=28u"PdNi+2u"Au/Sn
SN=Bright Tin
SM=Matte Tin

Series No.
01-99
Packing
0=PE Bag
T=Tube
Insulator Material
C=PA9T(Standard)
Pin Length
L(See Table)
Type:
S:S/T

Item	Pin Length	A	B	Mating
Standard	8.5	3.00	3.5	2135/2150T/2157
	9.0		4.0	2145/2150
	10.0		5.0	2168T/2171T
	10.8		5.84	2171/2185X
Standard	7.5	2.0 (THR)	3.5	2135/2150T/2157
	8.0		4.0	2145/2150
	9.0		5.0	2168T/2171T
	9.8		5.84	2171/2185X
Alternate				

Recommended P.C.B Layout (Top Side)
(PCB BOARD TOLERANCE±0.05)
(PCB Thickness: T=1.60mm)

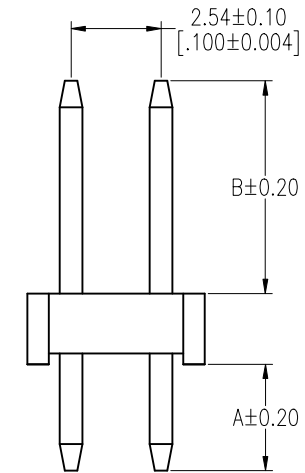
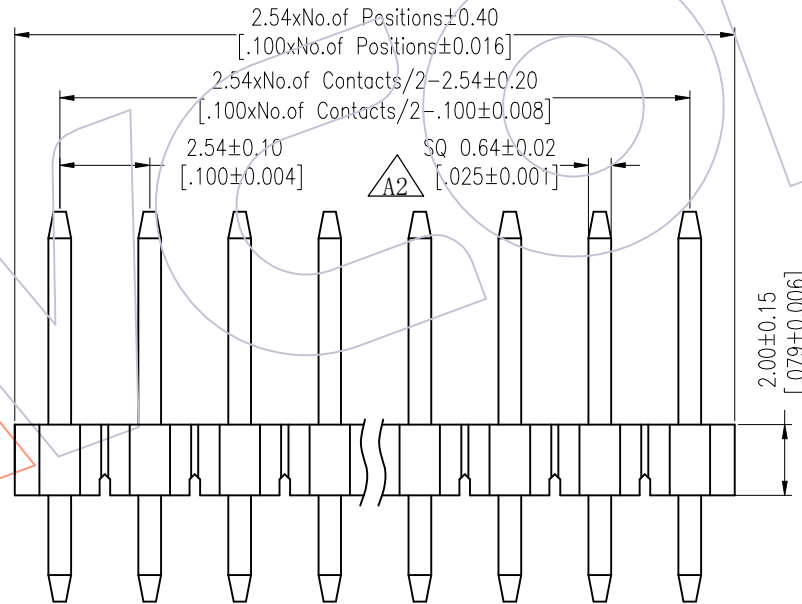
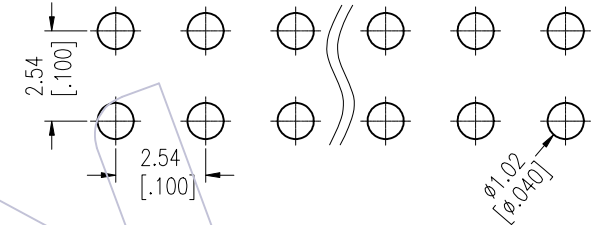
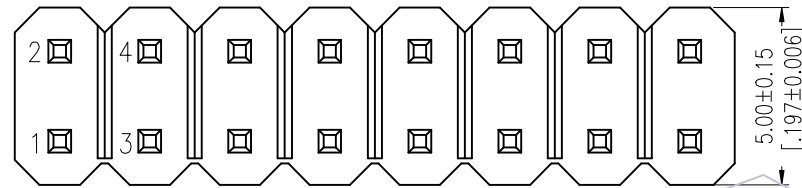

REV	DATE	MODIFICATION DESCRIPTION	CHANGE	OPERATION	DRAW	DATE	SCALE	Fit	PART NO.
A2	2025/03/24	Standardization Drawing	CP	x.X ±0.40	CP	2025/03/24	UNIT	mm	1120-12XXXXXXC0XX
A1	2018/01/22	Modify P/N	Ruipeng	x.XX ±0.25	CHECK	DATE	SIZE	A4	TITLE:
AO	2012/05/07	NEW	William Chen	x.XXX ±0.15	TANG	2025/03/24	SHEET	1/3	PH2. 54 DUAL ROW 180° H=2.0
				Angle ± 3'	APPROVE	DATE	PROJ.		Customer NO.
				DIM TOL	Steven Zhao	2025/03/24			



Http: www.wcon.com

WCON-Dongguan Tel: +86 769 85358920 Fax: +86 769 85358915 E-mail: sales@wcon.com	WCON-Kunshan Tel: +86 512 57468408 Fax: +86 512 57468468 E-mail: salesks@wcon.com
---	--

HSF

Packing:

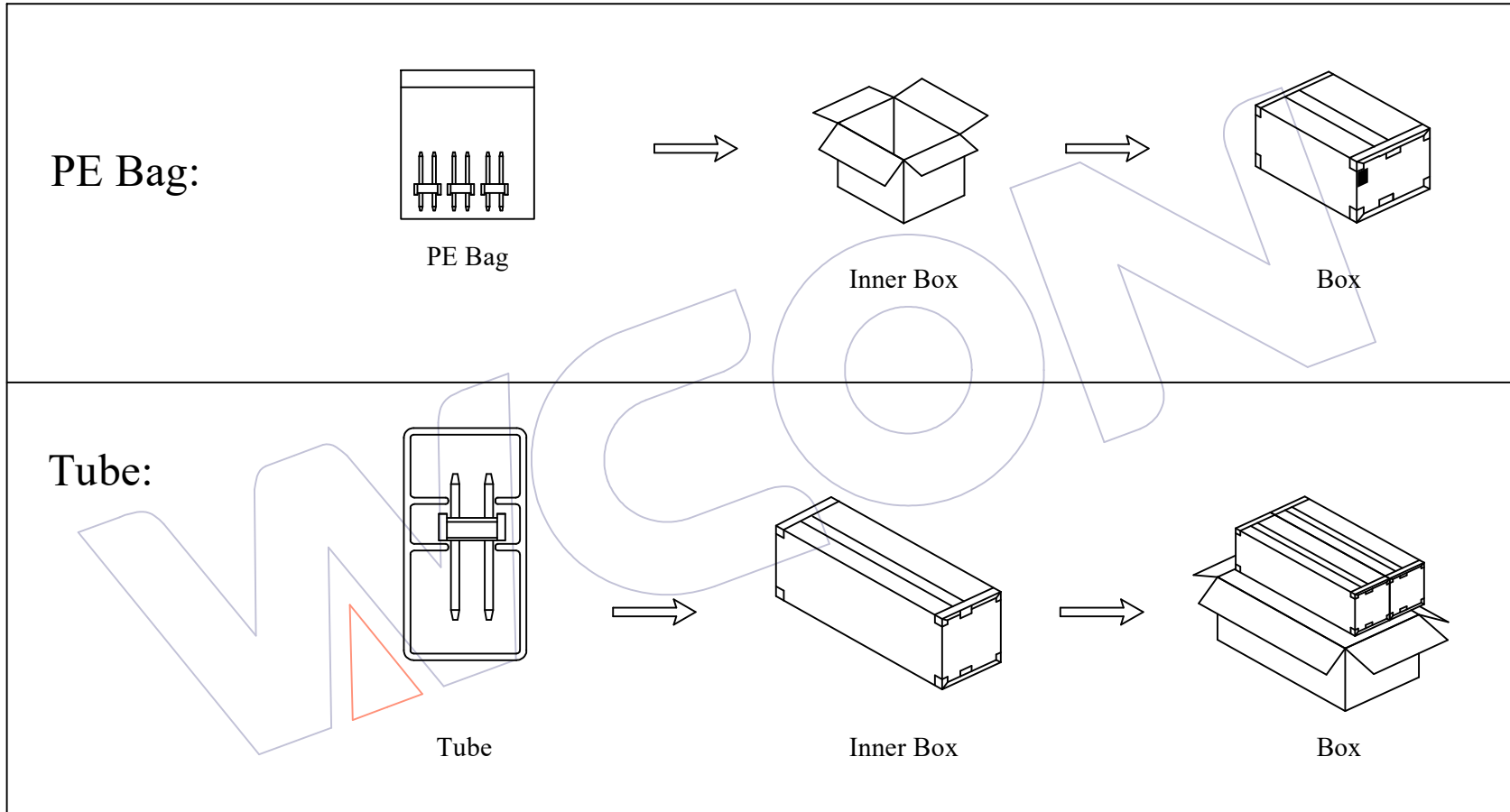

REV	DATE	MODIFICATION DESCRIPTION	CHANGE	OPERATION	DRAW	DATE	SCALE	Fit	PART NO.
A2	2025/03/24	Standardization Drawing	CP	x.X ±0.40	CP	2025/03/24	UNIT	mm	1120-12XXXXXXC0XX
A1	2018/01/22	Modify P/N	Ruipeng	x.XX ±0.25	CHECK	DATE	SIZE	A4	TITLE:
A0	2012/05/07	NEW	William Chen	x.XXX ±0.15	TANG	2025/03/24	SHEET	2/3	PH2.54 DUAL ROW 180° H=2.0
				Angle ± 3'	APPROVE	DATE	PROJ.		Customer NO.
				DIM TOL	Steven Zhao	2025/03/24			

WCON
 Http: www.wcon.com

WCON-Dongguan
 Tel: +86 769 85358920
 Fax: +86 769 85358915
 E-mail: sales@wcon.com

WCON-Kunshan
 Tel: +86 512 57468408
 Fax: +86 512 57468468
 E-mail: salesks@wcon.com

HSF

Packaging Quantity Refers To The Following Table

PINS /Row	Q' ty/Bag L≤10.0	PINS /Row	Q' ty/Bag L≤10.0	PINS /Row	Q' ty/Bag 10.0<L≤16.0	PINS /Row	Q' ty/Bag 10.0<L≤16.0
1	1000	21	200	1	1000	21	100
2	1000	22	200	2	1000	22	100
3	1000	23	200	3	1000	23	100
4	1000	24	200	4	1000	24	100
5	1000	25	200	5	1000	25	100
6	500	26	200	6	500	26	100
7	500	27	200	7	500	27	100
8	500	28	100	8	500	28	100
9	500	29	100	9	300	29	100
10	300	30	100	10	300	30	100
11	300	31	100	11	300	31	100
12	300	32	100	12	200	32	100
13	300	33	100	13	200	33	100
14	300	34	100	14	200	34	100
15	200	35	100	15	200	35	100
16	200	36	100	16	200	36	100
17	200	37	100	17	200	37	100
18	200	38	100	18	200	38	100
19	200	39	100	19	200	39	100
20	200	40	100	20	100	40	100

PINS /Row	Q' ty/Tube	Q' ty/Inner Box	Q' ty/Box	PINS /Row	Q' ty/Tube	Q' ty/Inner Box	Q' ty/Box
4	54	6,480	12,960	23	9	1,080	2,160
5	44	5,280	10,560	24	9	1,080	2,160
6	37	4,440	8,880	25	9	1,080	2,160
7	31	3,720	7,440	26	8	960	1,920
8	27	3,240	6,480	27	8	960	1,920
9	24	2,880	5,760	28	8	960	1,920
10	22	2,640	5,280	29	7	840	1,680
11	20	2,400	4,800	30	7	840	1,680
12	18	2,160	4,320	31	7	840	1,680
13	17	2,040	4,080	32	7	840	1,680
14	16	1,920	3,840	33	6	720	1,440
15	15	1,800	3,600	34	6	720	1,440
16	14	1,680	3,360	35	6	720	1,440
17	13	1,560	3,120	36	6	720	1,440
18	12	1,440	2,880	37	6	720	1,440
19	11	1,320	2,640	38	5	600	1,200
20	11	1,320	2,640	39	5	600	1,200
21	10	1,200	2,400	40	5	600	1,200
22	10	1,200	2,400				

A2	2025/03/24	Standardization Drawing	CP	OPERATION x.X ±0.40	DRAW CP	DATE 2025/03/24	SCALE UNIT	Fit mm	PART NO. 1120-12XXXXXXCOXX	 <p>Http: www.wcon.com</p> <p>WCON-Dongguan Tel: +86 769 85358920 Fax: +86 769 85358915 E-mail: sales@wcon.com</p> <p>WCON-Kunshan Tel: +86 512 57468408 Fax: +86 512 57468468 E-mail: salesks@wcon.com</p>
A1	2018/01/22	Modify P/N	Ruipeng	x.XX ±0.25	CHECK	DATE 2025/03/24	SIZE A4		TITLE: PH2.54 DUAL ROW 180° H=2.0	
A0	2012/05/07	NEW	William Chen	x.XXX ±0.15	TANG	DATE 2025/03/24	SHEET 3/3		Customer NO.	
REV	DATE	MODIFICATION DESCRIPTION	CHANGE	Angle ± 3° DIM TOL	APPROVE Steven Zhao	DATE 2025/03/24	PROJ.			